



WALL INLETS

The nozzle is comprised of concentric eyeballs of 1.4mm, 20mm and 25mm fitted one inside the other like onion rings. With the help of the eyeball cutter, it is possible to select the desired dimension/flow rate.

Multiflow Wall Inlets

Φ50mm internal for glueing and Φ2" external (threaded) for concrete pools. This can be used with wall conduit PA00324.

Max, recommended flowrate for Φ 14mm=2.0m³/hr;
Φ 20mm=4.5m³/hr; Φ 25mm=7.0m³/hr

Made of white ABS plastic, available in options for concrete and liner pools.

Φ 50mm internal for glueing and Φ 2" external (threaded).
For Liner Pools



PA00295C

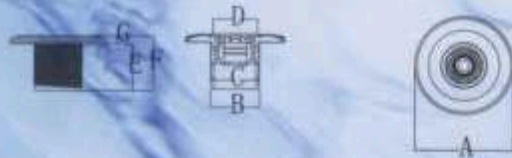

Model	A	B	C	D	E	F	G
PA00295C	118.90	2"	50.00	53.87	56.65	66.55	9.9

*Size in mm



PA00295V

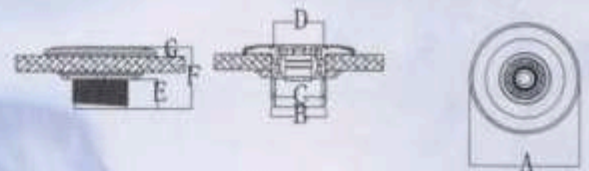

Model	A	B	C	D	E	F	G
PA00295V	118.90	2"	50.00	53.87	31.72	66.55	9.90

*Size in mm

Φ 50mm internal for glueing and Φ 60mm external (non threaded). For concrete pool can be used with wall conduit PA00324E



PA00298

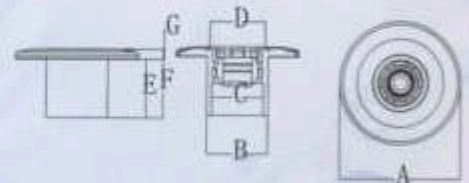

Model	A	B	C	D	E	F	G
PA00298	118.90	2"	50.00	53.87	56.65	66.55	9.90

*Size in mm

White Parts